

FOIL STUDIO PRO

“TURN TONER INTO TREASURE”



USER MANUAL - JANUARY 2026
VERSION 1

Hello lovely crafters

Thank you for choosing the Foil Studio Pro. This machine is built to help you create crisp, shiny, professional foiled results from your laser printed designs using toner reactive foil.

We created Foil Studio Pro to give UK crafters a reliable, great value foiling machine with results you can be proud of, whether you craft occasionally or foiling is basically a personality trait.

If you ever need help, you can reach me directly:

Support email: ray@foilstudiopro.co.uk

Phone: 07502 105535

Happy Foiling

Ray



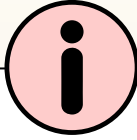

IMPORTANT SAFETY INFORMATION

- DO plug the machine into a grounded outlet.
- DO use the machine on a stable surface.
- DO test on scrap sheets before final foil application.
- DO keep the machine away from water, moisture, flammable liquids, and explosive or corrosive substances.
- DO turn off the machine after each use.
- DO keep away from pets while in use.
- DO place all materials entirely inside transfer folder.
- DO NOT use machine if the power cord is damaged.
- DO NOT attempt to open or otherwise repair the machine.
- DO NOT insert sharp objects into machine.
- DO NOT allow materials to exceed 0.60 mm thick.
- DO NOT allow children to use this machine without adult supervision.
- DO NOT foil metal objects (eg: staples, paper clips, brads, eyelets, etc.).
- DO NOT foil heat-sensitive items and materials (eg: ultrasounds, light weight plastics, etc.).

DISCLAIMER

This product should only be used in accordance with the instructions provided in this manual. Failure to follow these instructions may result in damage to the product, property, or personal injury.

Foil Studio Pro™ accept no responsibility or liability for any loss, damage, injury, or consequential damages arising from misuse, improper handling, unauthorised modifications, or use of this product for purposes other than those intended.

Always operate the machine in a safe environment and keep it away from children and pets unless under adult supervision. Any repairs or servicing should only be carried out by authorised personnel.

The information in this manual is subject to change without prior notice. The manufacturer reserves the right to make improvements or modifications to the product at any time.

By using this product, the user agrees to assume all responsibility for its safe operation and proper use.

COPYRIGHT

© 2025 Foil Studio Pro Limited. All rights reserved.

No part of this manual may be reproduced, distributed, or transmitted in any form or by any means, including photocopying, recording, or other electronic or mechanical methods, without the prior written permission of the copyright owner.

Get to know your machine

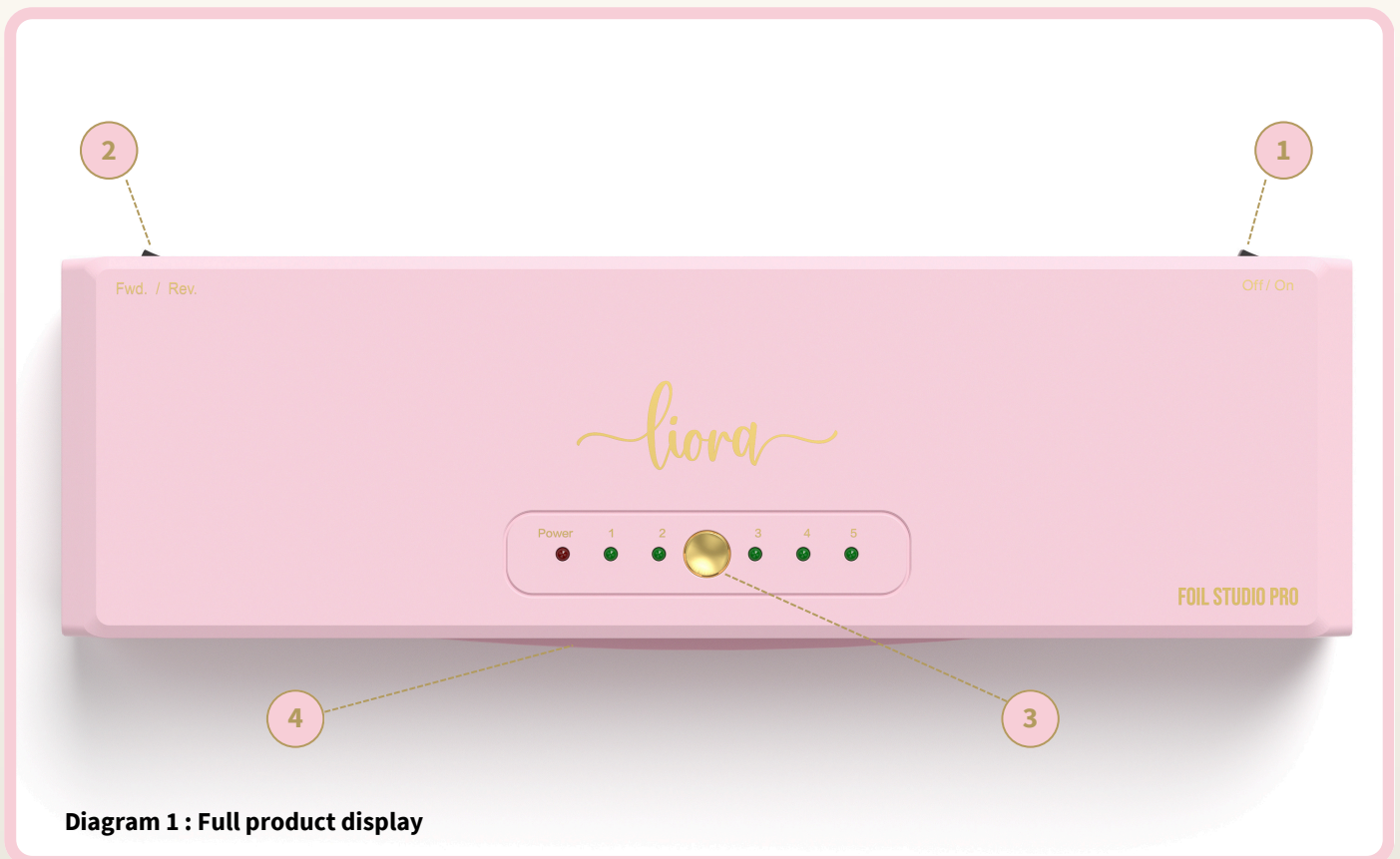

1.	Main power switch
2.	Forward and reverse switch
3.	Heat control panel
4.	Transfer wallet feed slot

Six simple steps to perfect results

Follow these six simple steps to achieve even and flawless foil coverage, remember to make sure your printed design, transfer wallet and foil is free from dust and debris.

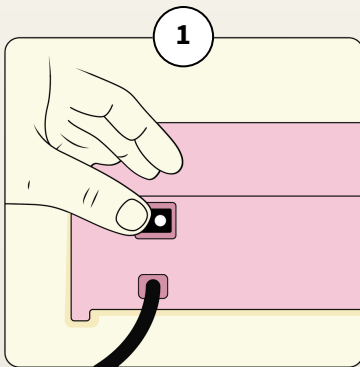

Turn the machine on using the main switch located at the back

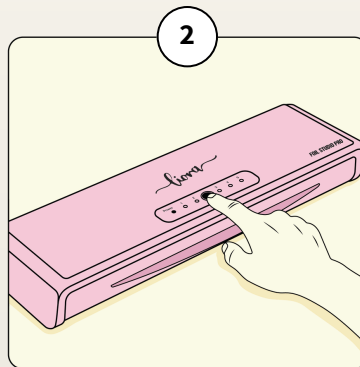

Select the desired heat setting and allow the machine to warm up

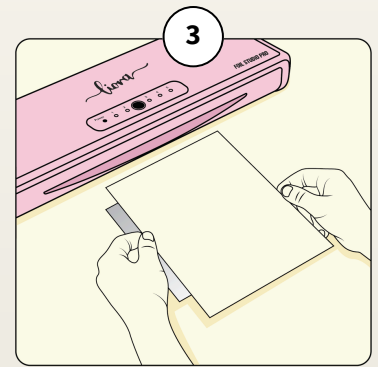

Cut your toner reactive foil and place it on top of your laser printed design

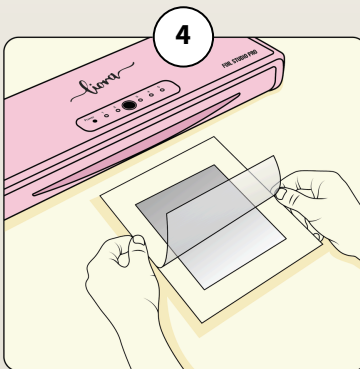

Place it in a heat resistant wallet, ensure no dust is present

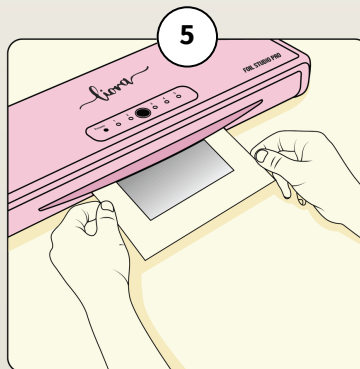

Feed the wallet into the machine, until you feel the machine taking the wallet

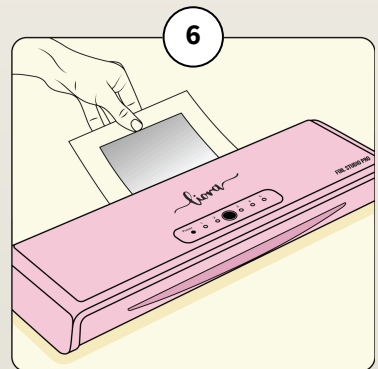

Allow the wallet to fully pass through the machine and remove it from the back

Carefully peel away the foil to unveil your beautifully transformed design "a shimmering finish to treasure"

Selecting the correct heat setting

The settings below are for guidance purposes only, each brand of paper and media may react differently therefore it is best to run a small test before moving onto big projects.

Ideally, paper and media should be smooth to give toner reactive foil the best chance to adhere evenly.

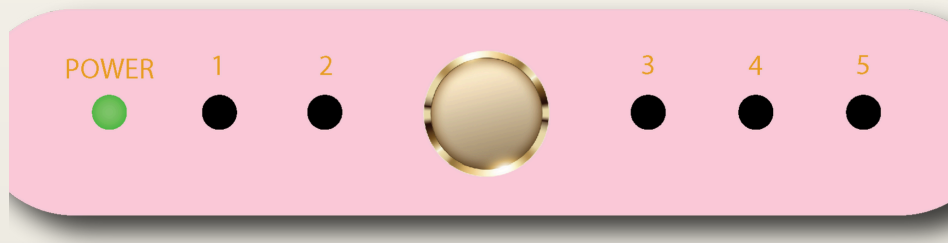

Setting	Recommended Use
Power	Pressure with no heat, use for even adhesive laminate overlays
1	Vellum paper and stamping foil/overlay
2	Lightweight coated paper & glossy stickers
3	Lightweight uncoated paper & heavyweight coated paper
4	Cardstock 280gsm and above
5	Cardstock 310gsm and above

What do I need to create stunning designs?



A RELIABLE FOILING MACHINE

Your machine is the heart of the process. A consistent and even heat source is essential for smooth, flawless foil transfer. The Foil Studio Pro is designed to deliver professional-quality results every time – with no foil rotation needed and easy, intuitive controls and 4 perfectly aligned rollers.



GOOD QUALITY TONER REACTIVE FOIL

Not all foils are created equal. To achieve that beautiful mirror-shine finish, make sure you're using toner-reactive foils, these are specially designed to bond with toner when heat and pressure are applied. Smooth foil means smooth results ✨

There's plenty available to choose from but the range from Patsy May have been tried and tested with our machine and give flawless results.

Head over to www.patsymay.co.uk to see their range of over 130 foil colours and patterns.



A LASER PRINTER (NOT INKJET!)

Toner is the magic ingredient. Unlike inkjet, laser printers use toner powder, which reacts perfectly with foils. For best results, we recommend the Brother HL-L2400 – a reliable mono laser printer that gives crisp, clean prints every time.

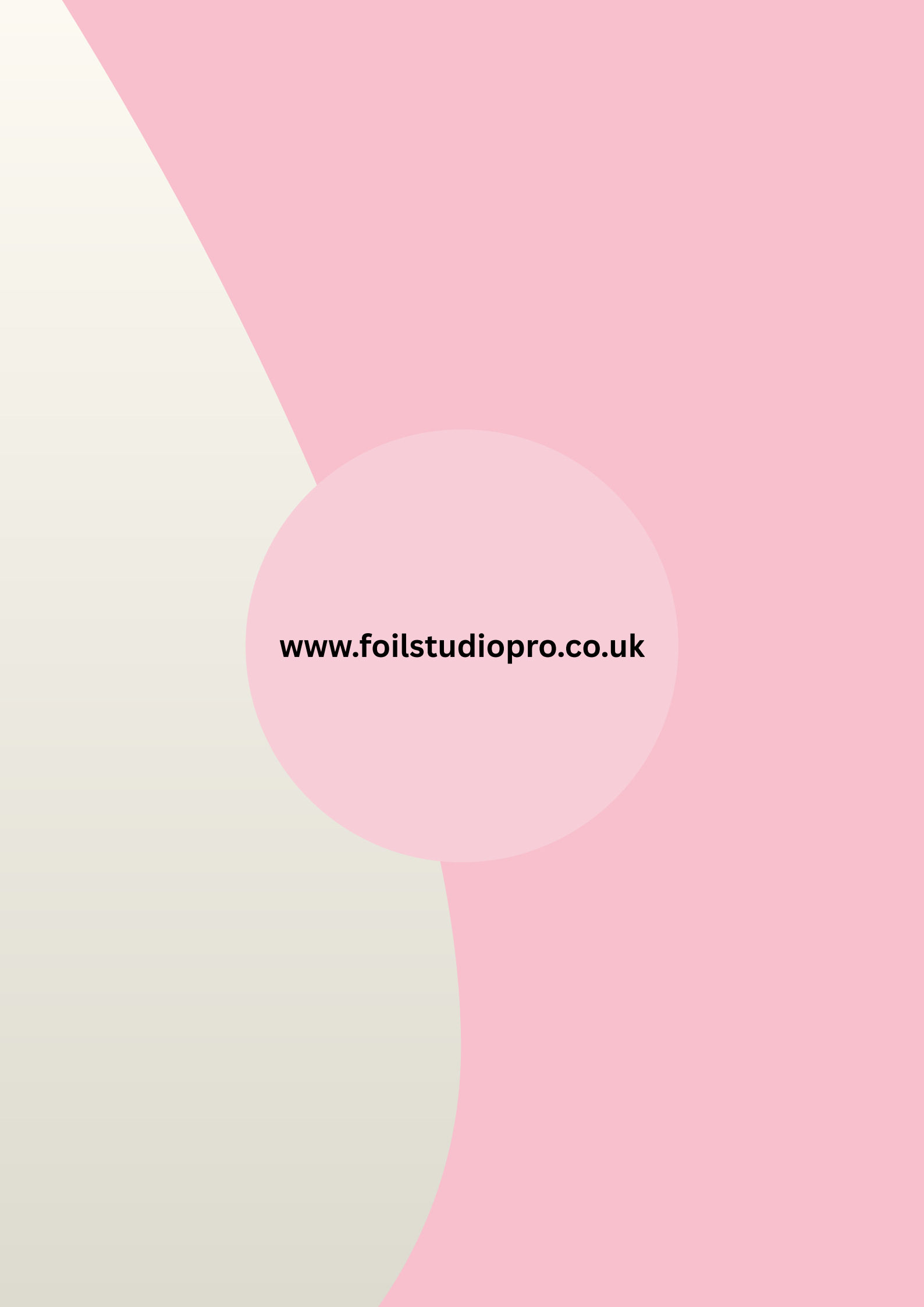

www.foilstudiopro.co.uk